

Material	Manufactured in selected engineered laminated pine or hardwood, sourced from sustainable and managed forestry (FSC or PFEC certified)
Aluminium cladding	External aluminium cladding available in full RAL colour range, provides weather resistance and easy maintenance
Mechanism	Sashes operated on multiple turning mechanism with dual opening action, which allows ventilation and easy cleaning from the inside
Security (optional)	Fully tested to Secure by design standards PAS 24:2012
Weatherseal	The window is fully weather sealed to BS EN 6375-1 2009
Glass	The window is factory glazed and can take dual or triple sealed units up to 48mm thickness
Thermal Performance	Thermal performance is calculated by the standards of EN ISO 10077-1:2006 and this window achieves a U-value from 1.3 W/m²K down to 0.8 W/m²K
Glazing Bars	Applied bars are used to achieve the slim section of traditional glazing bars. These are applied with double sided glazing tape to both faces of the sealed unit and capped with clear silicone
Cill extensions	Manufactured from extruded aluminium with options of cill projections and end caps
Fittings	Dual action fastener to each operable sash with options in colour and finish. Concealed hinges is an option
Ventilation	A controllable trickle ventilator can be fitted to the window dependant on width of frame (See Drawing No TT-A-78/11)
Factory Finishing	To ensure the smooth operation and optimum performance of the window, we apply 3 coats of sprayed applied microporous water based paint system

PRODUCT TYPE

ALUMINIUM CLAD
TILT & TURN WINDOW

TITLE

ELEVATION DRAWING

DRAWING No.

TT-A-78/01

DATE

2020/11/17

SCALE

CONSTRUCTION DETAILS

Eksalta
Windows
& Doors

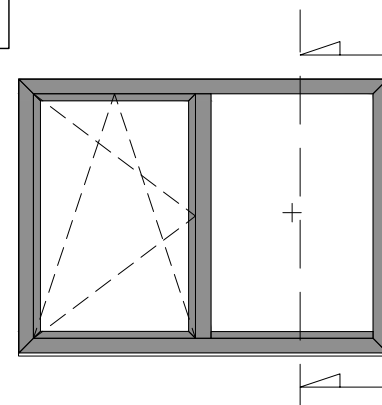
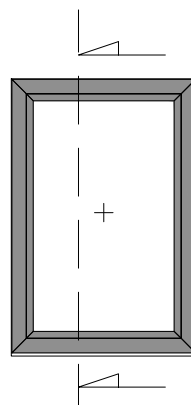
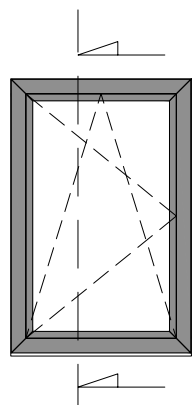
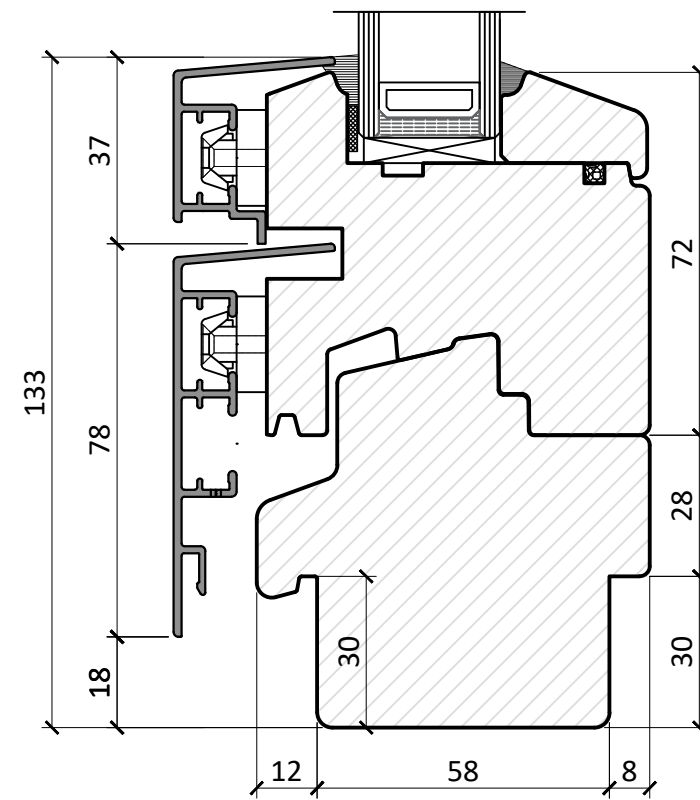
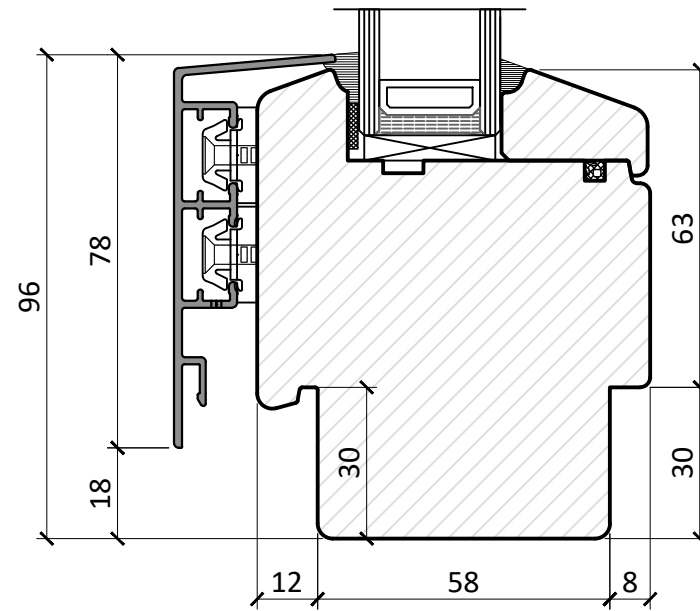
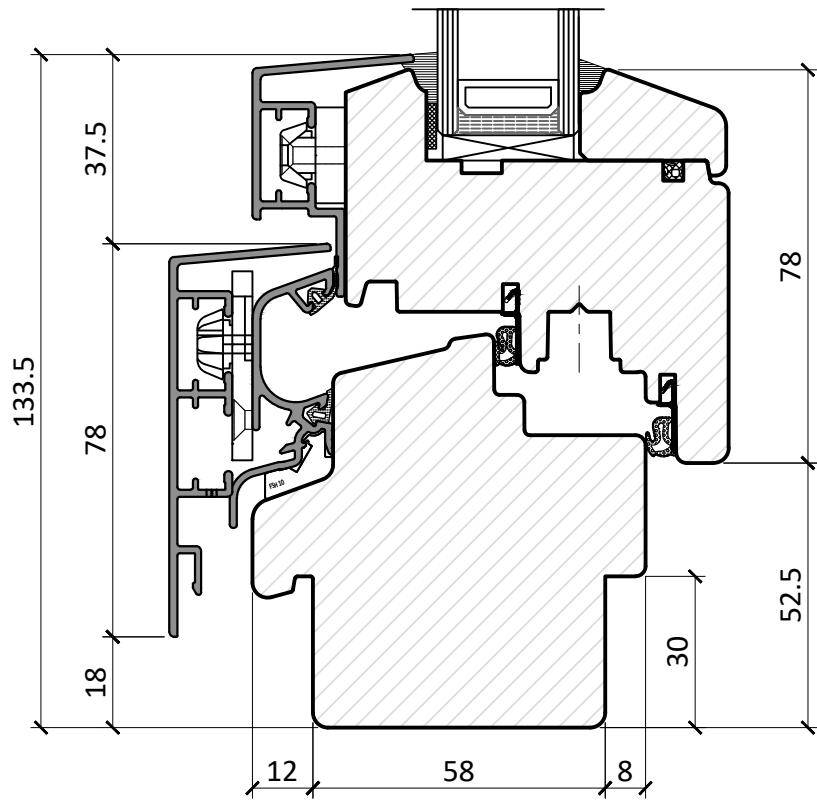
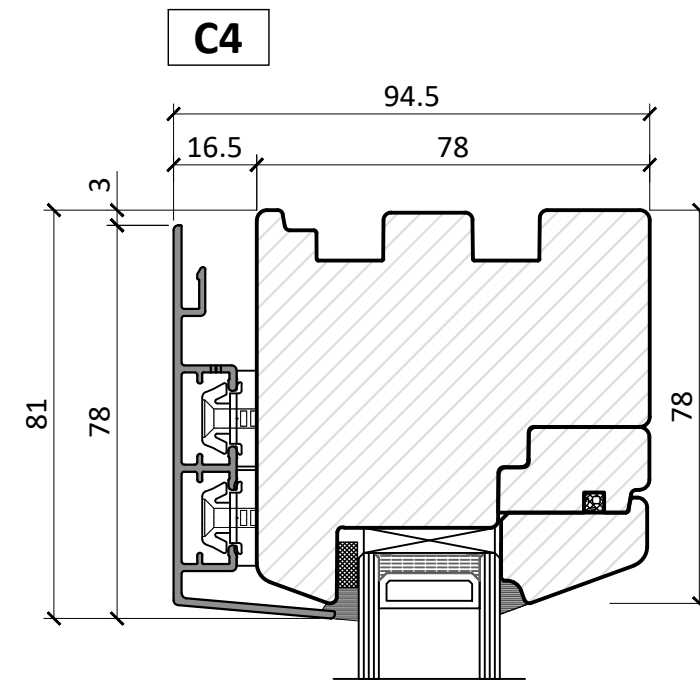
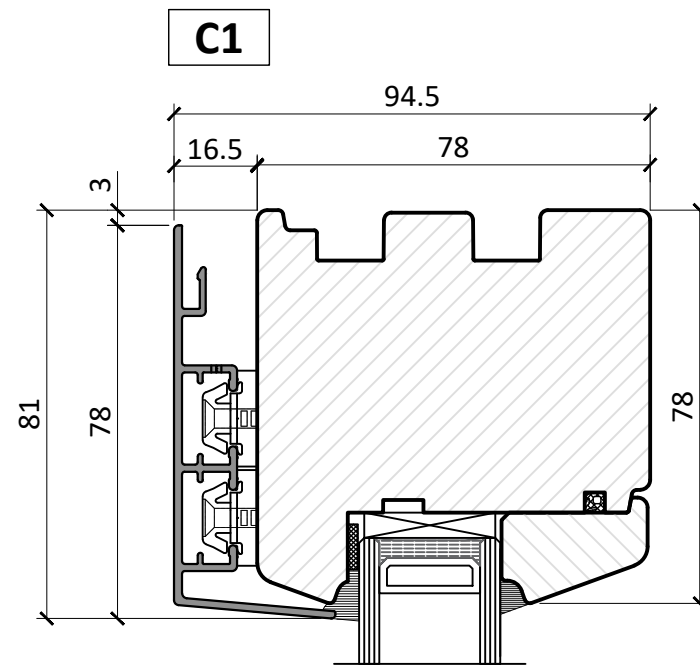
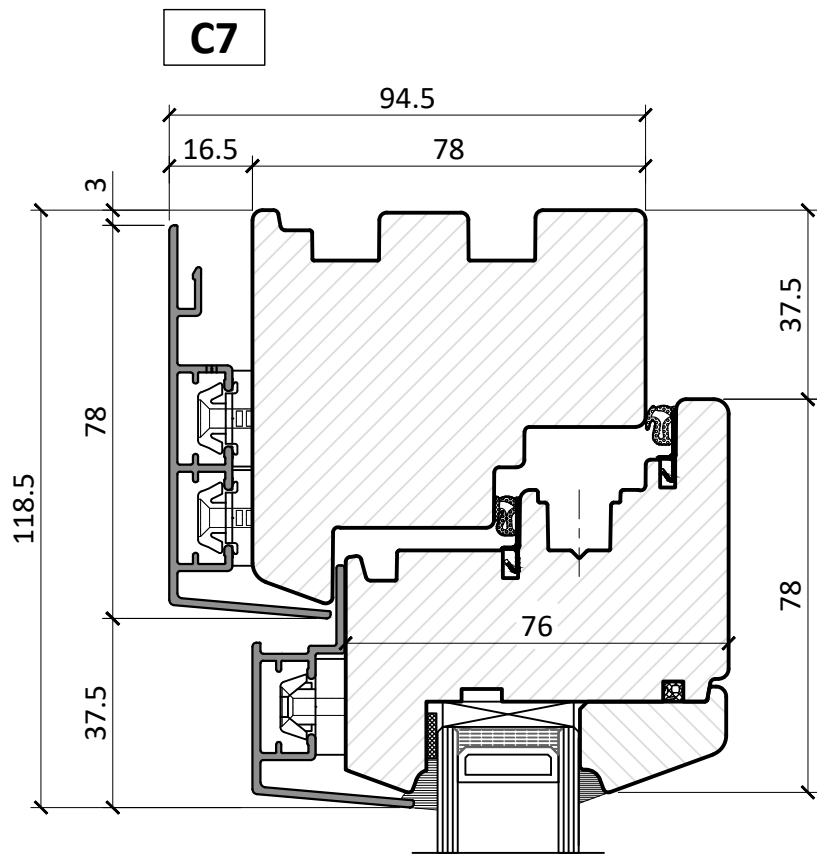

PRODUCT TYPE	
ALUMINIUM CLAD TILT & TURN WINDOW	
TITLE	
VERTICAL SECTION	
DRAWING No.	
TT-A-78/02	
DATE	SCALE
2020/11/17	1:1.5 @ A3
CONSTRUCTION DETAILS	

PRODUCT TYPE

**ALUMINIUM CLAD
TILT & TURN WINDOW**

TITLE

HORIZONTAL SECTION

DRAWING No.

TT-A-78/03

DATE

2020/11/17

SCALE

1:1.5 @ A3

CONSTRUCTION DETAILS

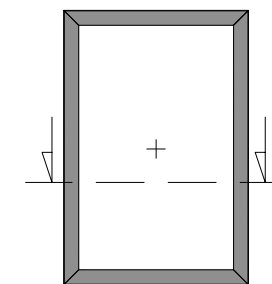
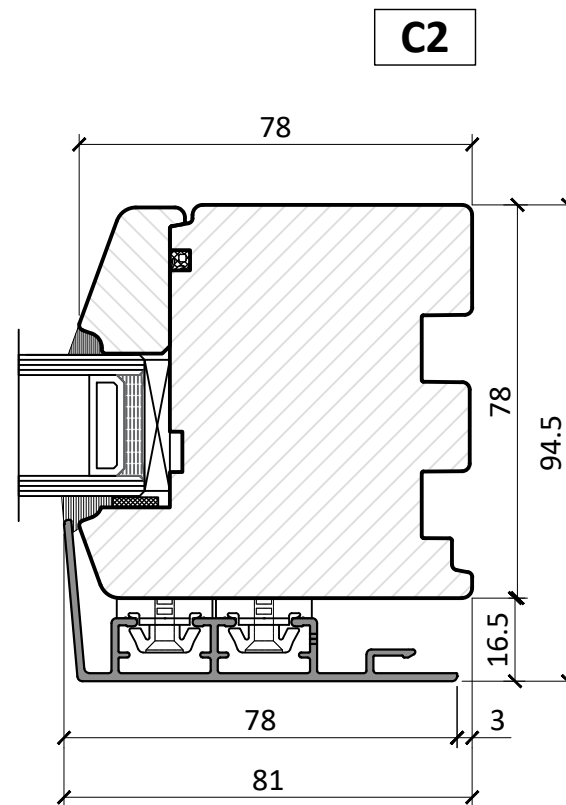
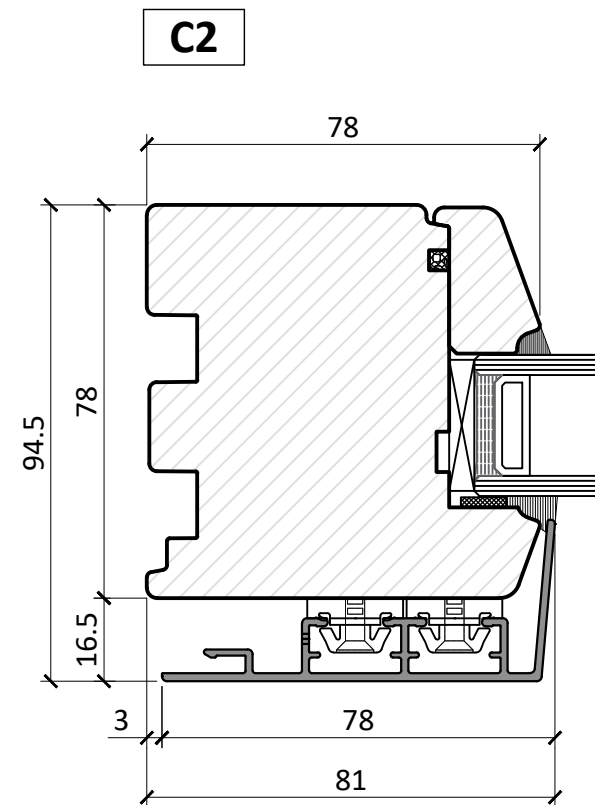
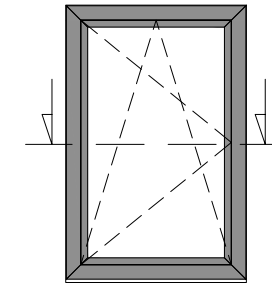
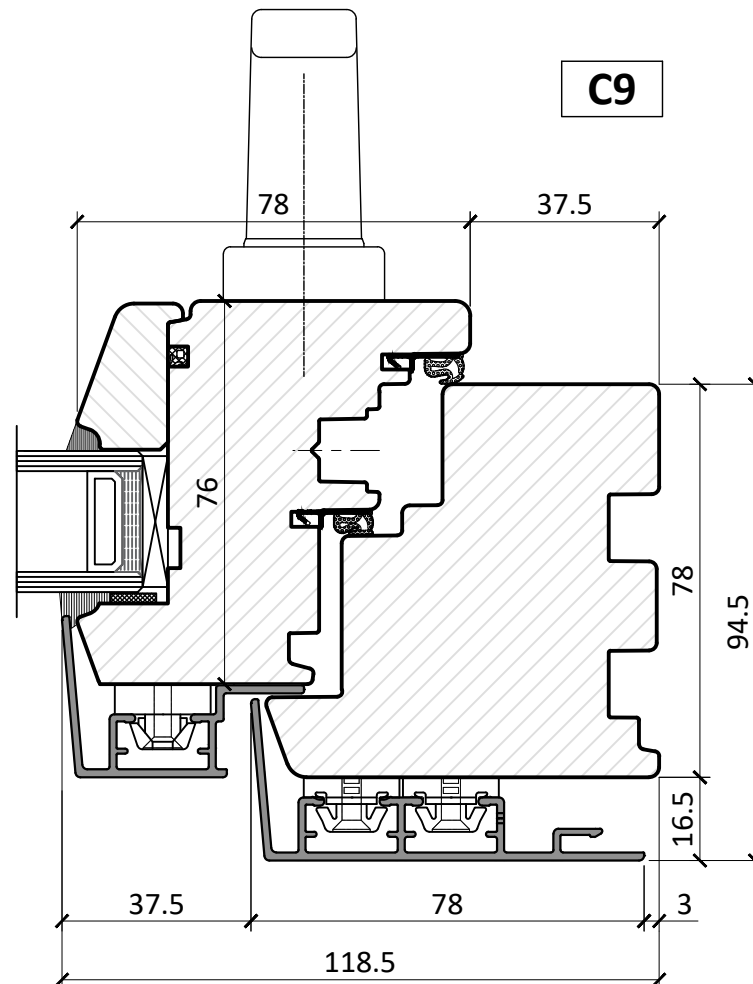
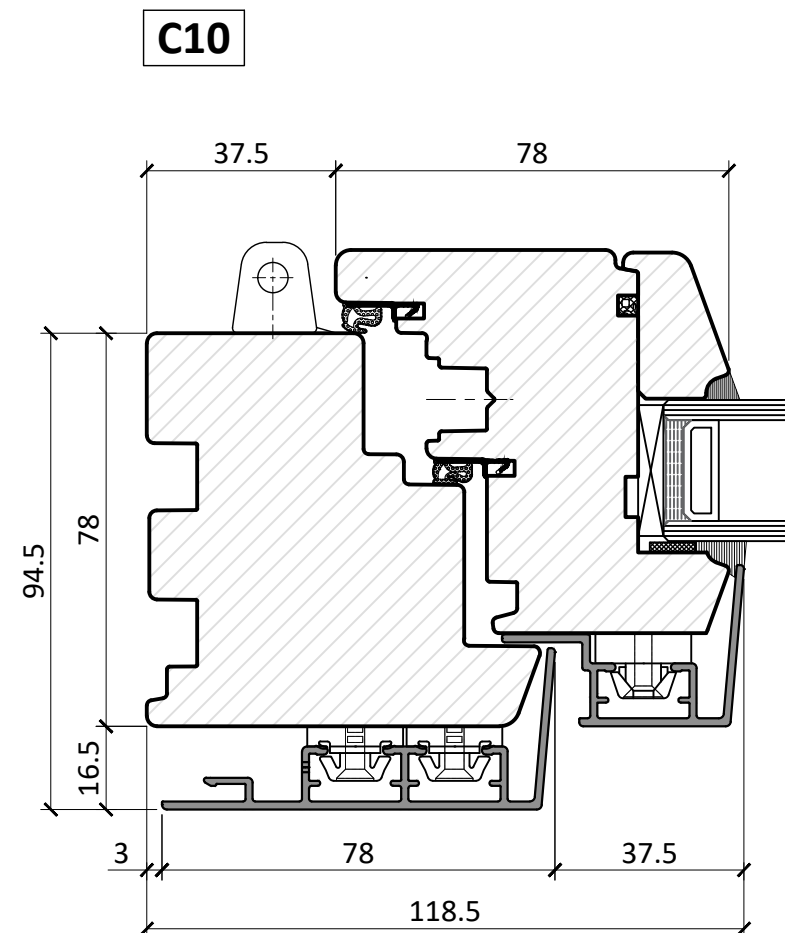

C11

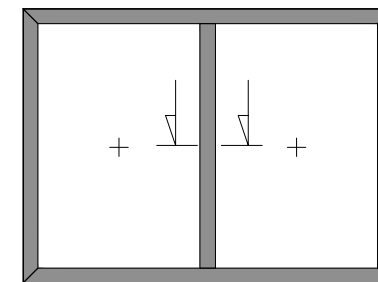
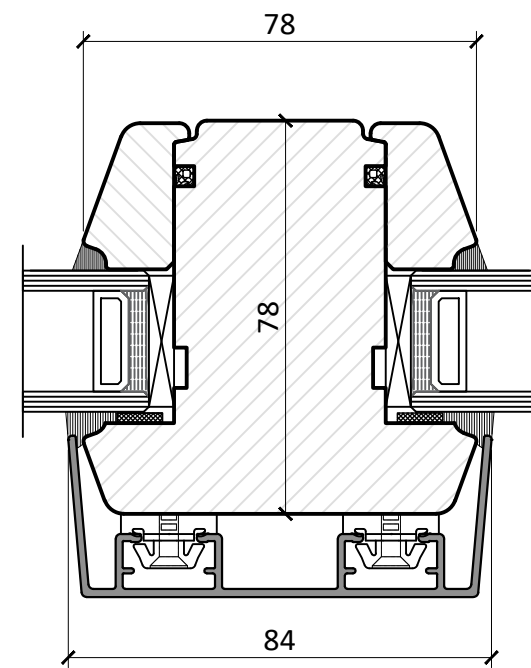

DIRECT GLAZED

C12

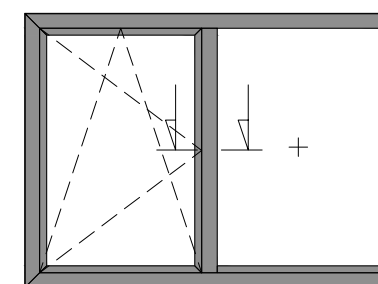
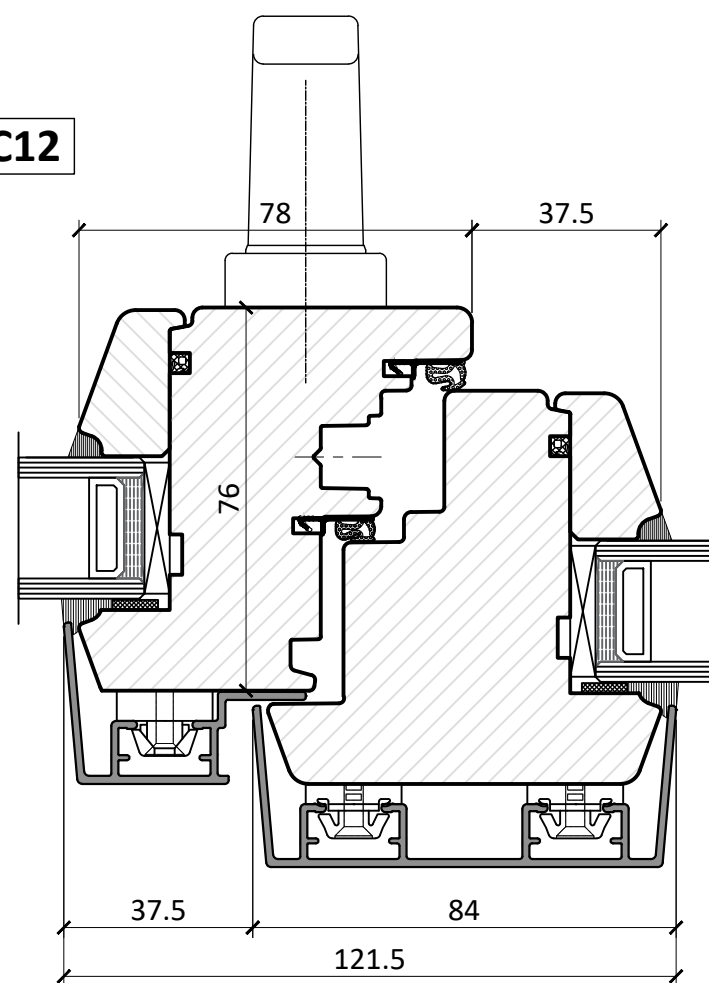

TILT & TURN NEXT TO
DIRECT GLAZED

PRODUCT TYPE	
ALUMINIUM CLAD TILT & TURN WINDOW	
TITLE	
MULLION DETAILS	
DRAWING No.	
TT-A-78/04	
DATE	SCALE
2020/11/17	1:1.5 @ A3
CONSTRUCTION DETAILS	

C15

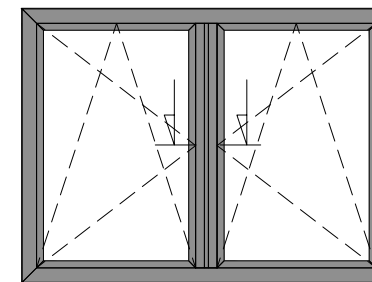
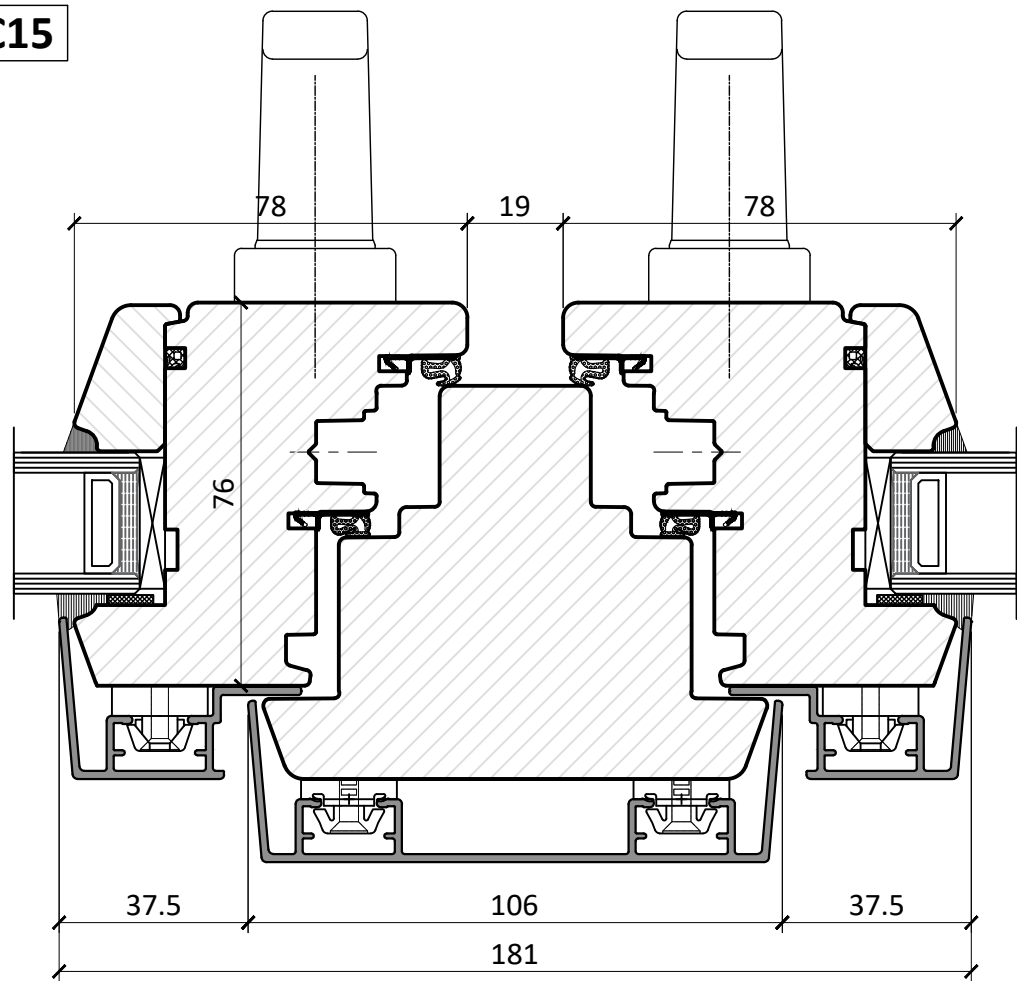

DOUBLE TILT & TURN

C18

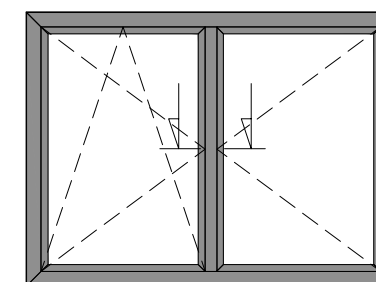
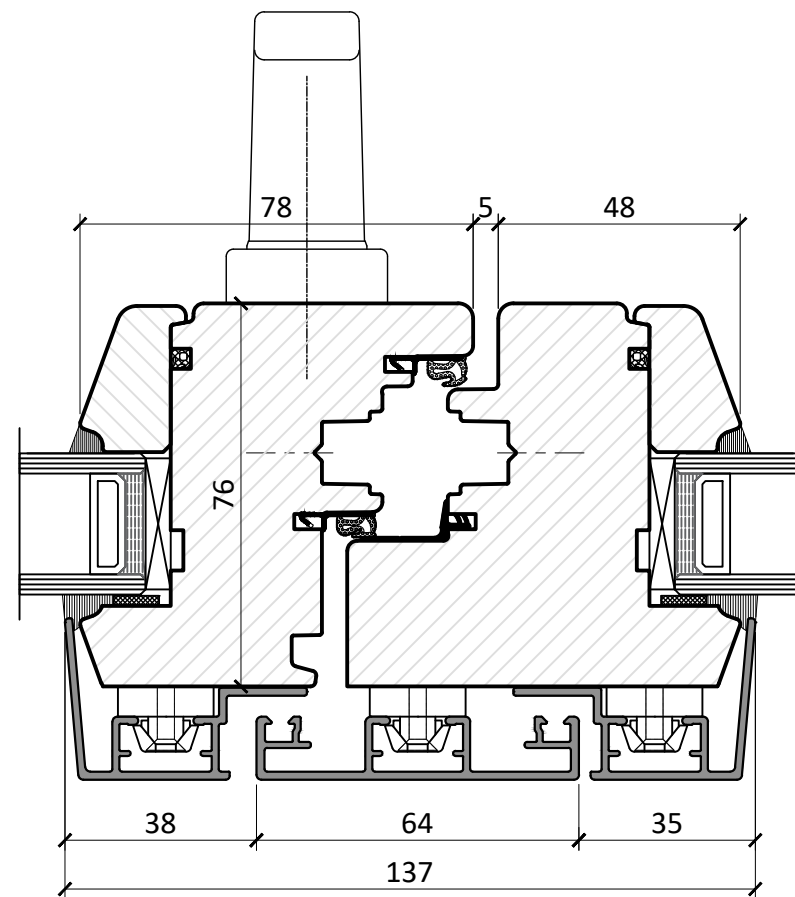

TILT & TURN WITH
FLOATING MULLION

PRODUCT TYPE	
ALUMINIUM CLAD TILT & TURN WINDOW	
TITLE	
MULLION DETAILS	
DRAWING No.	
TT-A-78/05	
DATE	SCALE
2020/11/17	1:1.5 @ A3
CONSTRUCTION DETAILS	

PRODUCT TYPE

**ALUMINIUM CLAD
TILT & TURN WINDOW**

TITLE

TRANSOM DETAILS

DRAWING No.

TT-A-78/06

DATE	SCALE
2020/11/17	1:1.5 @ A3

CONSTRUCTION DETAILS

C19

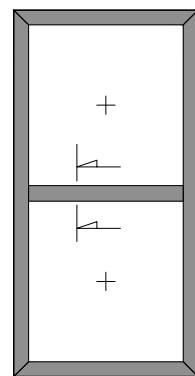
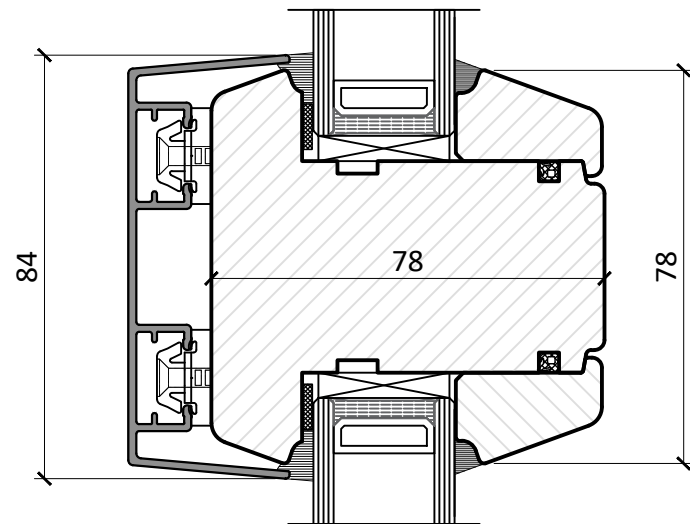

C21

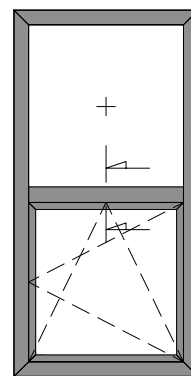
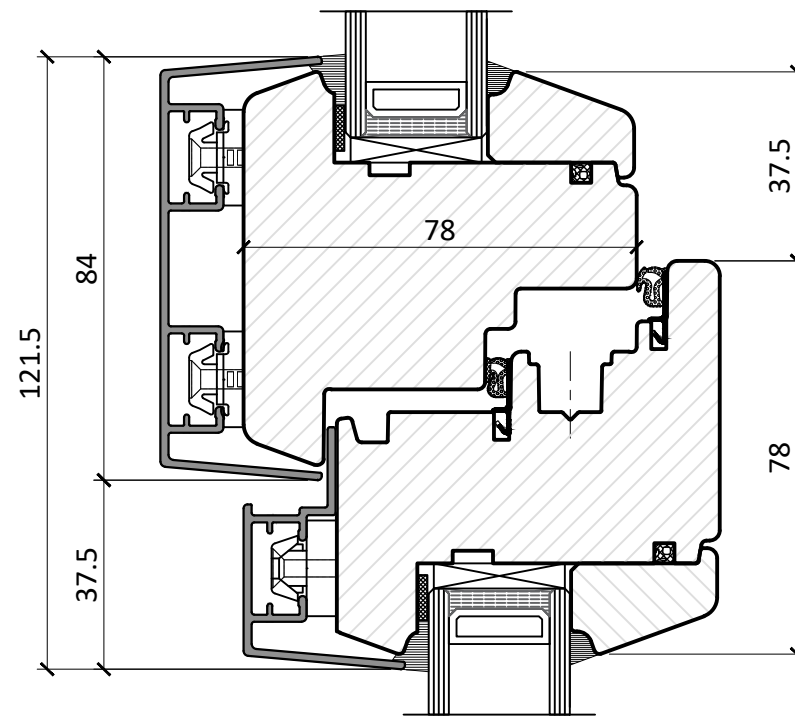

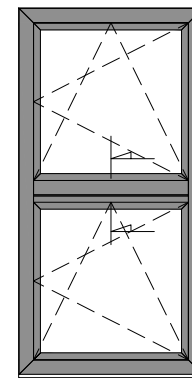
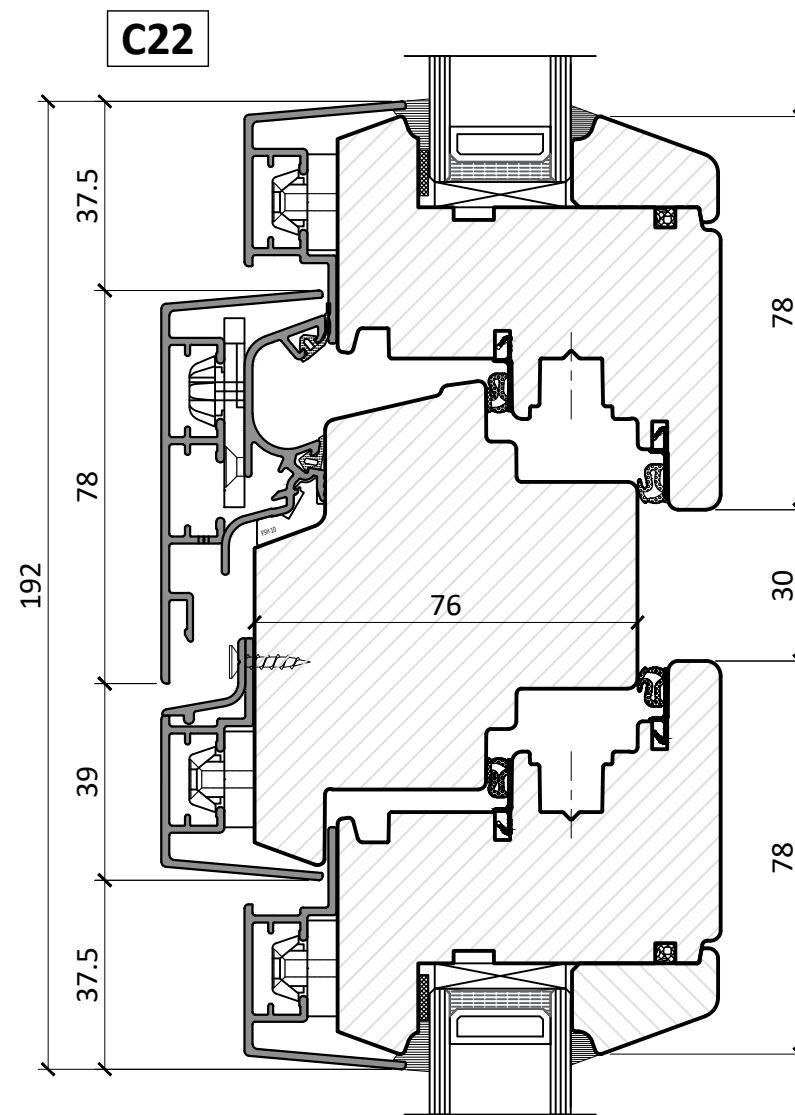
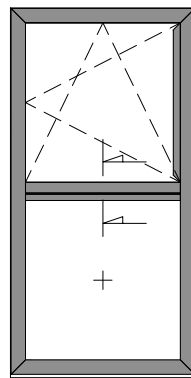
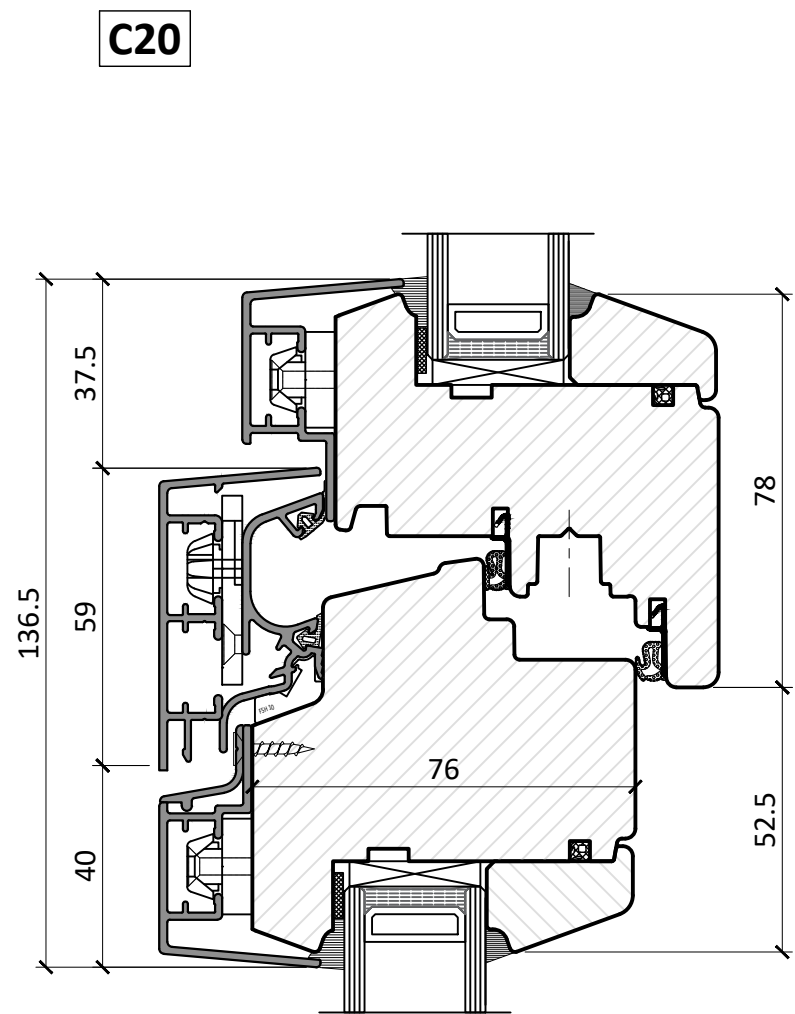

PRODUCT TYPE	
ALUMINIUM CLAD TILT & TURN WINDOW	
TITLE	
TRANSOM DETAILS	
DRAWING No.	
TT-A-78/07	
DATE	SCALE
2020/11/17	1:1.5 @ A3
CONSTRUCTION DETAILS	

PRODUCT TYPE

ALUMINIUM CLAD
TILT & TURN WINDOW

TITLE

GLAZING AND GLAZING
BAR DETAILS

DRAWING No.

TT-A-78/08

DATE

2020/11/17

SCALE

1:1.5 @ A3

CONSTRUCTION DETAILS

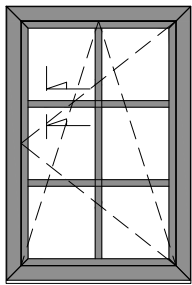
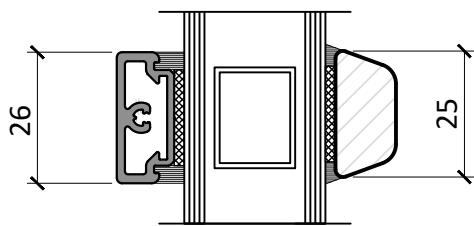
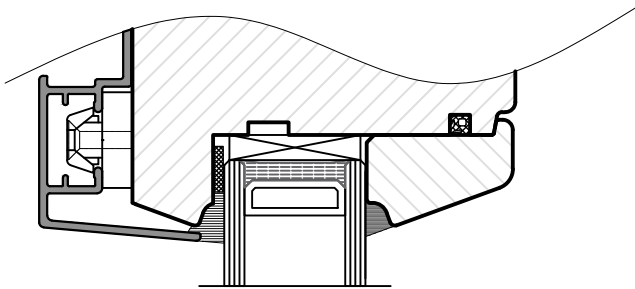

Double glazed

Triple glazed

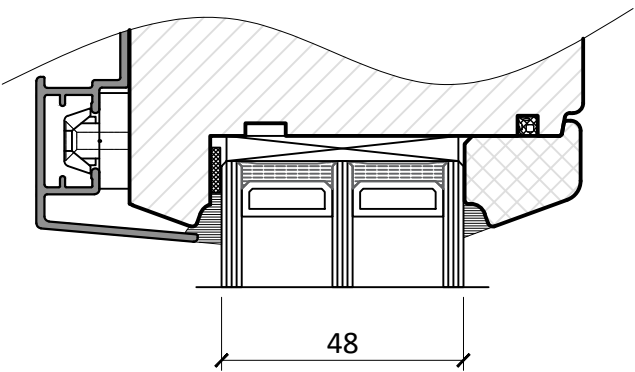
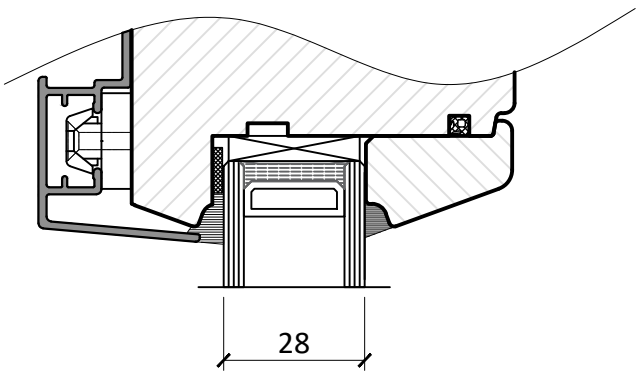

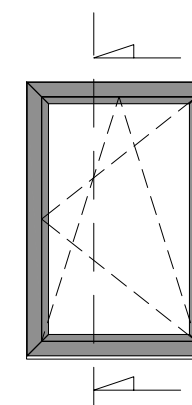
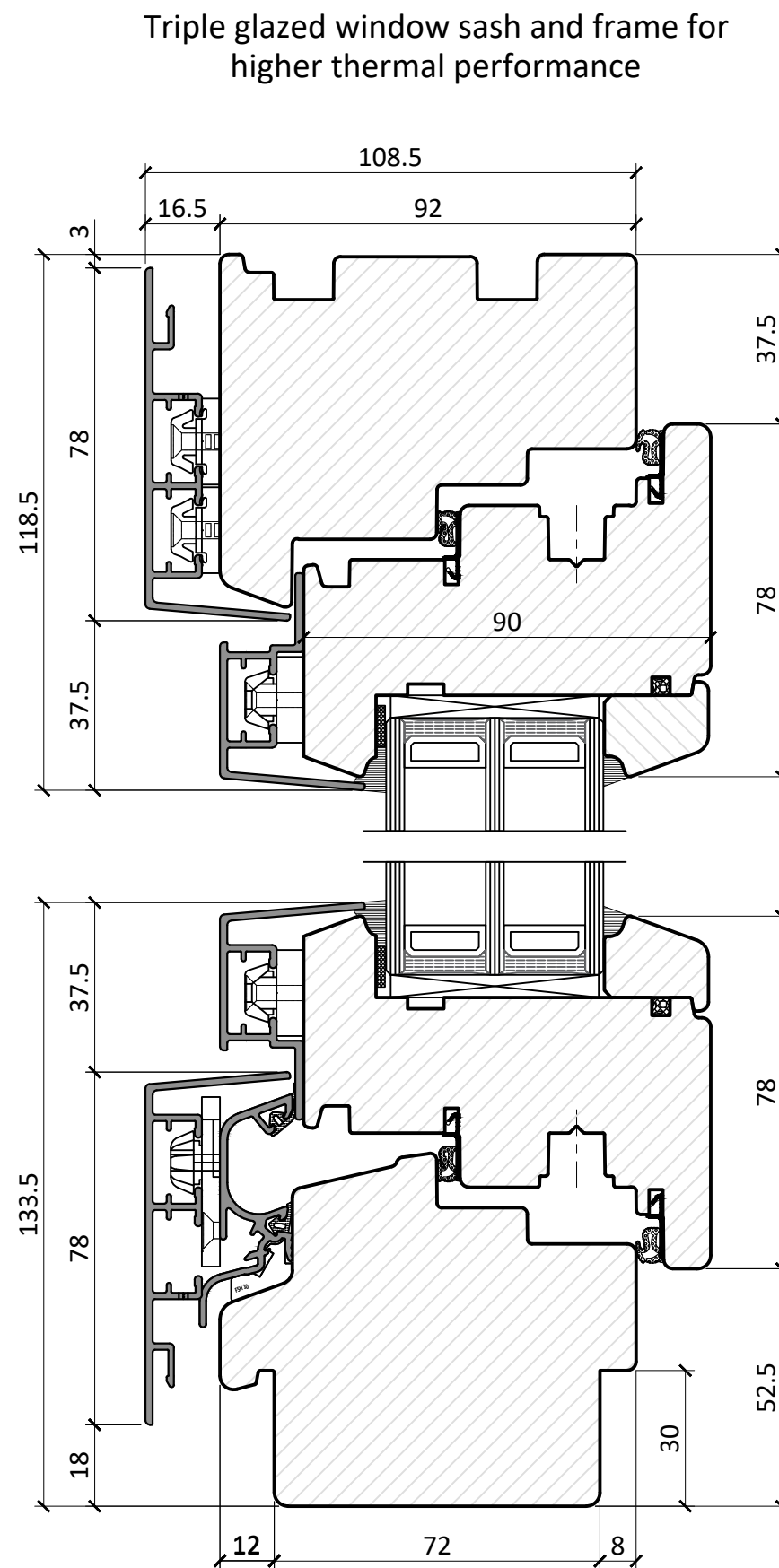
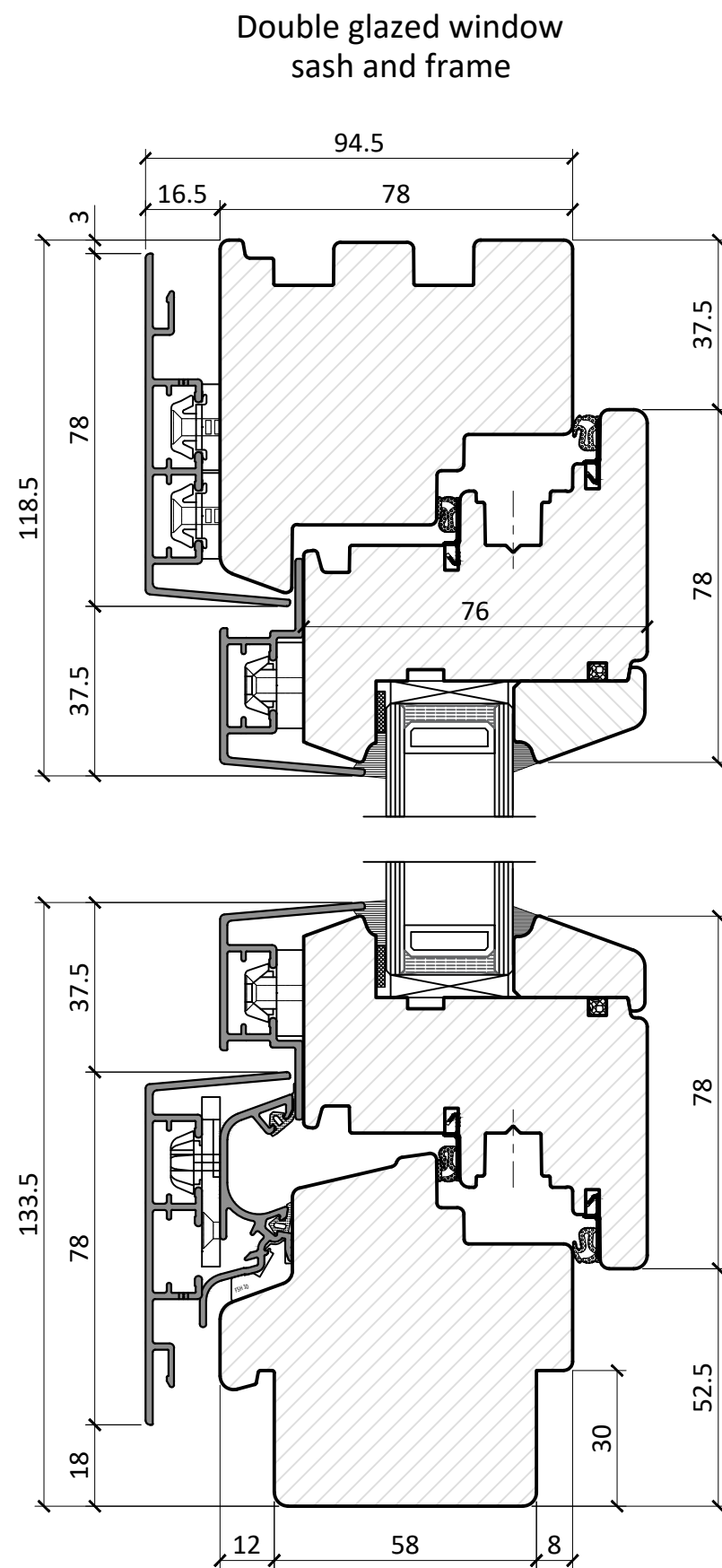

PRODUCT TYPE	
ALUMINIUM CLAD TILT & TURN WINDOW	
TITLE	
SASH AND FRAME OPTIONS	
DRAWING No.	
TT-A-78/09	
DATE	SCALE
2020/11/17	1:1.5 @ A3

CONSTRUCTION DETAILS

ALUMINIUM CLAD
TILT & TURN WINDOW

TITLE

CILL EXTENSION OPTIONS

DRAWING No.

TT-A-78/10

DATE

2020/11/17

SCALE

1:1 @ A3

CONSTRUCTION DETAILS

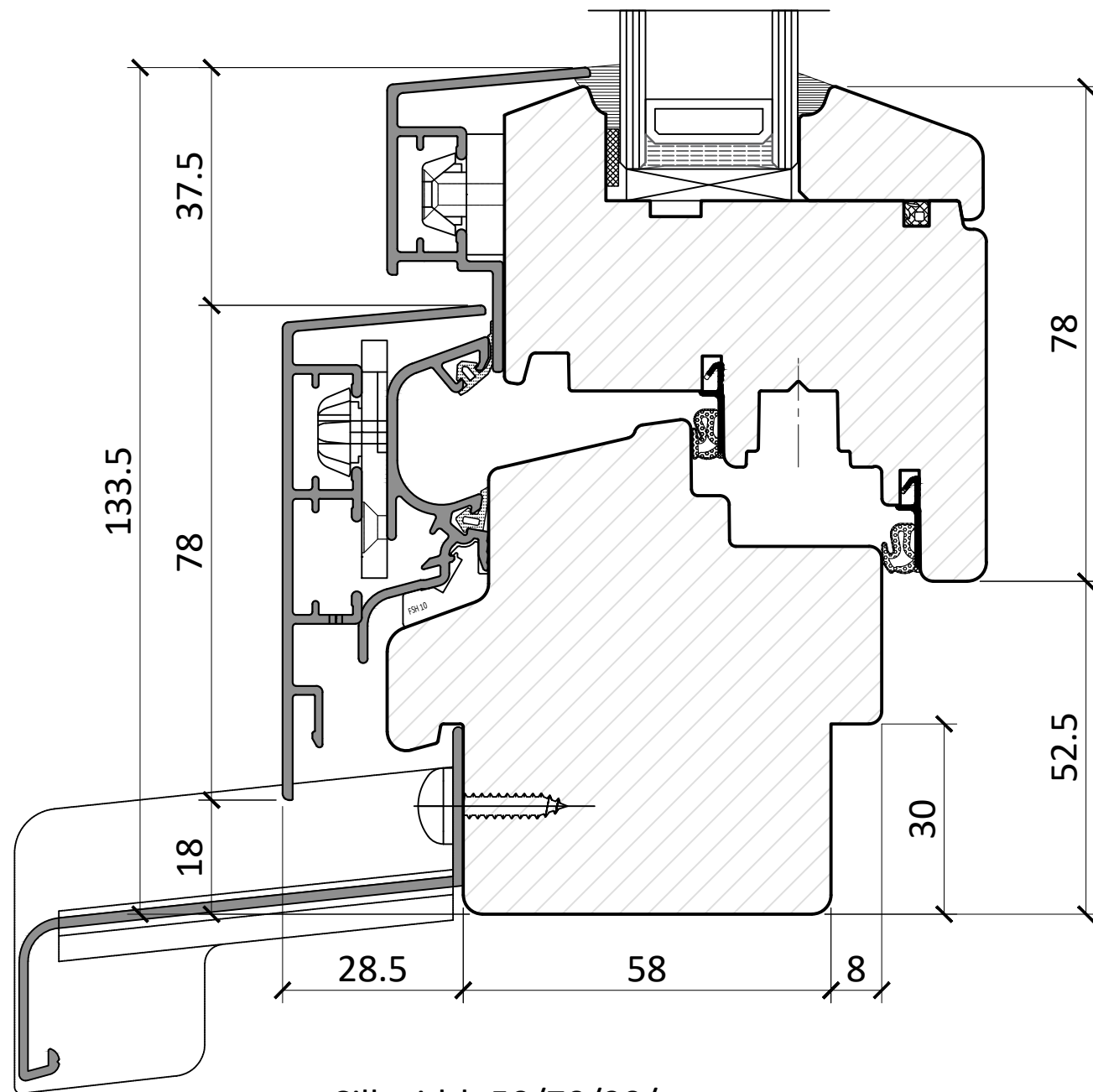

Cill width 50/70/90/
110/130/150/165/180/195/
210/225/240/260/280/
300/320/340/360

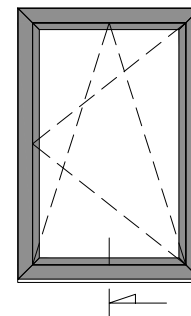
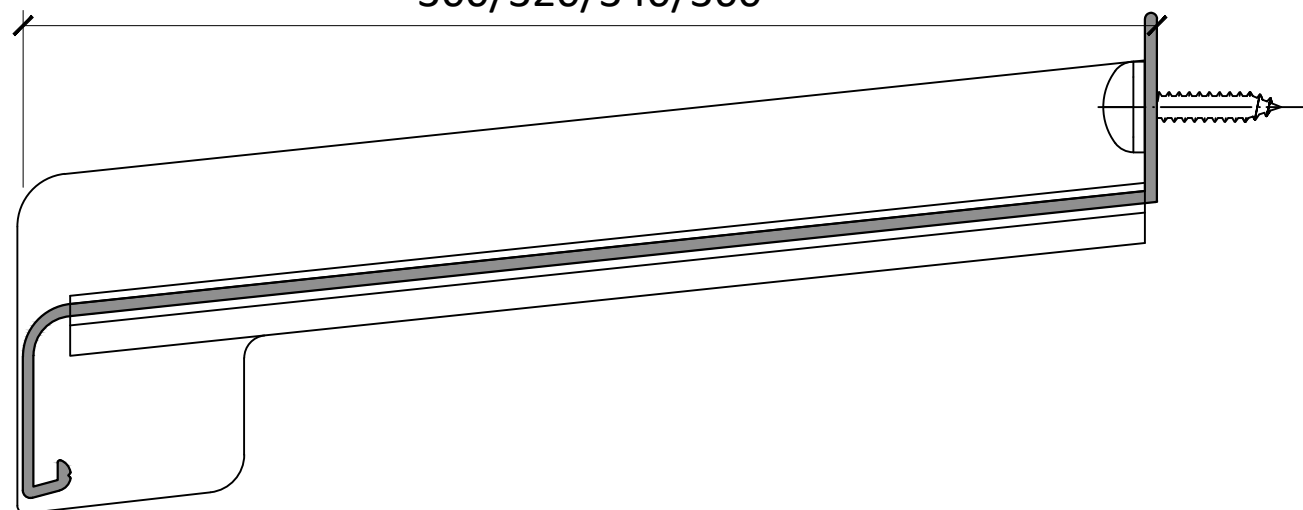

ALUMINIUM CLAD TILT & TURN WINDOW

TITLE

TRICKLE VENT

DRAWING No.

TT-A-78/11

DATE

2020/11/17

SCALE

1:1.5 @ A3

CONSTRUCTION DETAILS

C1/78V

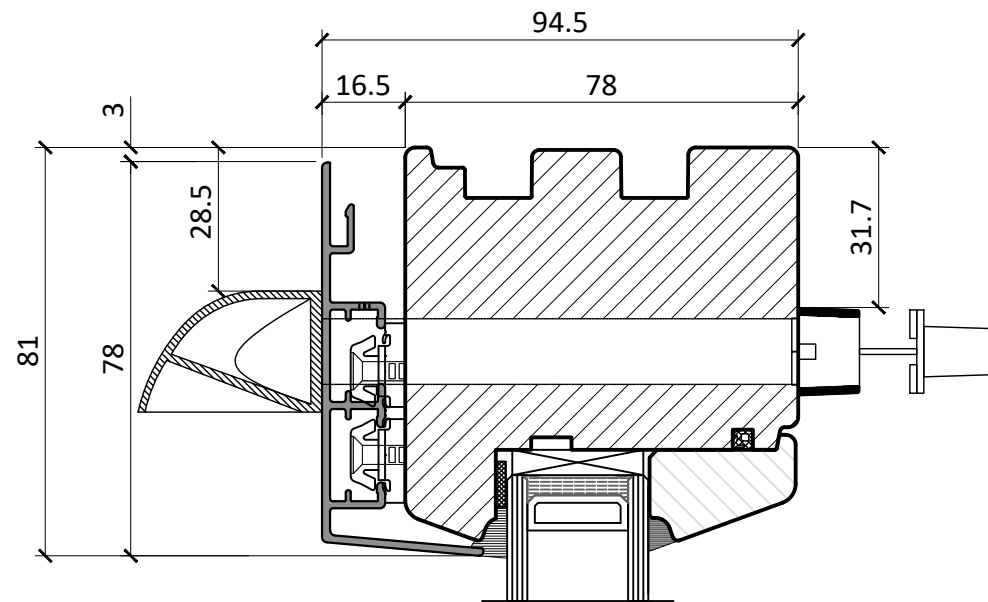

C7/100V

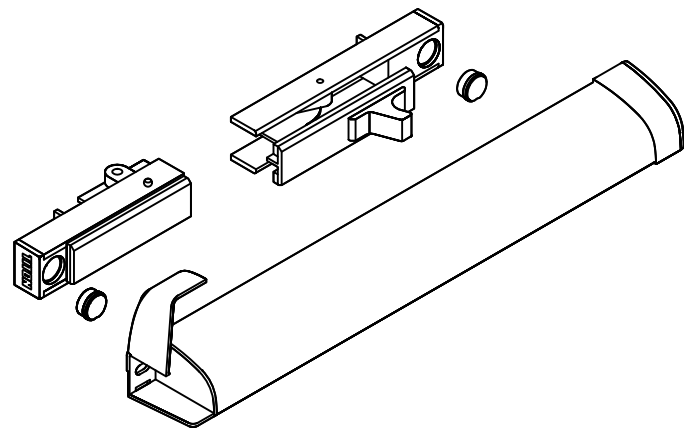
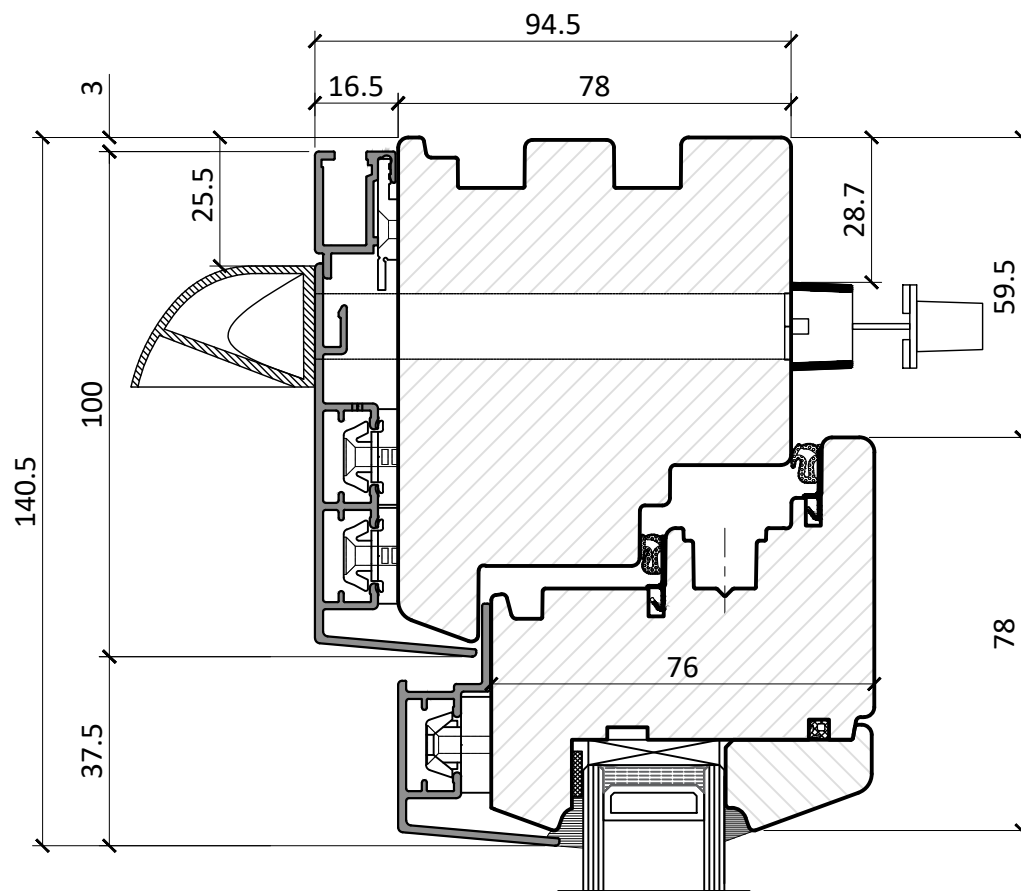

TRICKLE VENT AVAILABLE IN DIFFERENT
AIR FLOW VALUE, DEPENDING ON THE
SASH/WINDOW WIDTH:

- * - 2200 mm² EA
- * - 4000 mm² EA
- * - 6000 mm² EA

